

# Combo-Micro Valve Pneumatic Controls

## 1.5 cu. ft Vessel

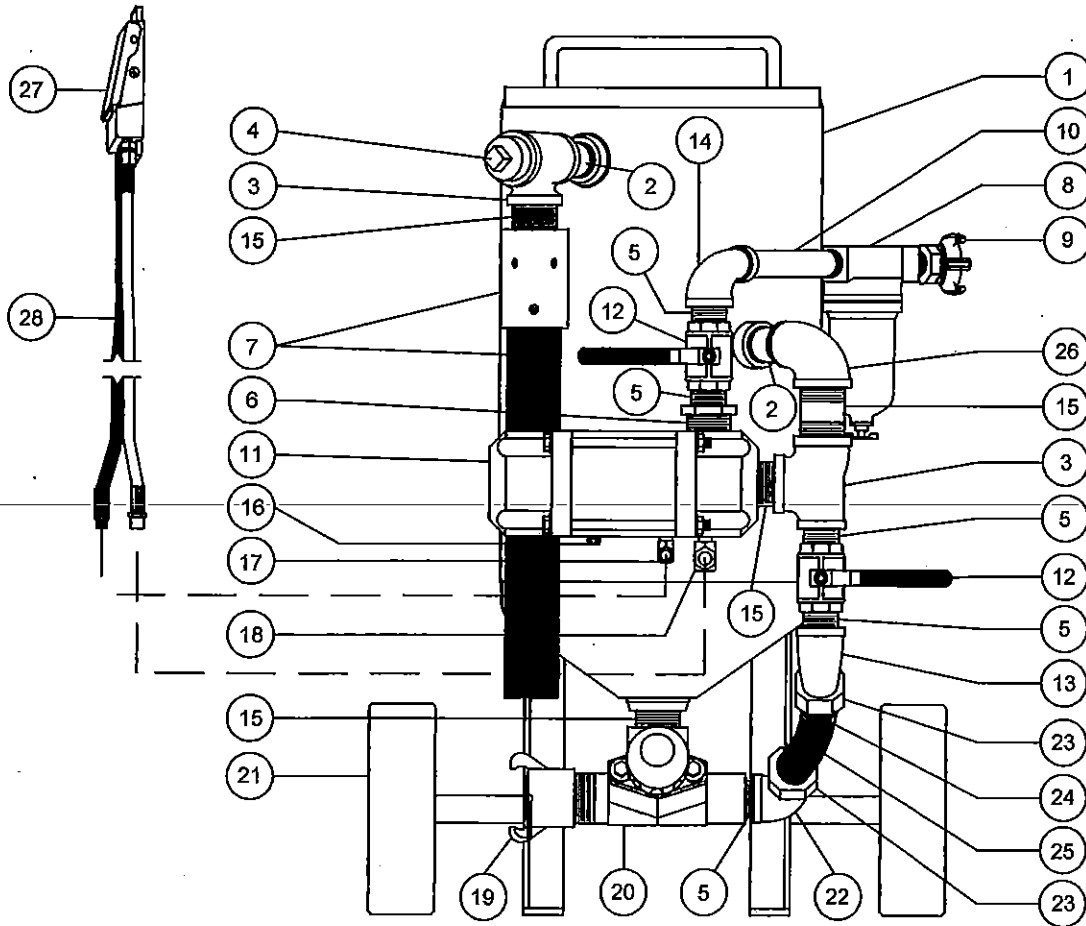

1" Piping with Combo-Micro Valve

No.	Part No.	Description	No.	Part No.	Description
1.	See page 3	Portable Vessel	16.	2014-300	Breather Vent, 1/8"
2.	3029-006-11	Nipple, 1" x 3"	17.	4203-500-00	90° Swivel, 1/8" x 1/8"
3.	3013-007-06	Reducing Tee, 1 1/4" x 1"	18.	4203-502-02	90° Swivel, 1/4" x 1/4"
4.	3014-007	Plug, 1 1/4"	19.	4214-108-01	Blast Hose Coupling with gasket
5.	3029-006-99	Nipple, 1" x close	4209-999	Gasket	
6.	3026-007-06	Bushing, 1 1/4" x 1"	20.	2125-106	Micro Valve, 1" (See page 14)
7.	4115-005	Blowdown Hose Assembly	21.	7040-003	Axle (as of April, '95)
	4215-405	Nozzle Holder		7046-002	Wheel
	4104-005	Blast Hose (per foot)		7019-519	Nut, 3/4"
8.	2302-205-50	Moisture Separator, 3/4"	22.	3006-106	90° Street Elbow, 1"
9.	4208-105	Crowfoot, 3/4" 2 lug male with gasket	23.	4205-106	Swivel Insert, 1" with gasket
	4209-999	Gasket		4205-106-99	Gasket
10.	3029-005-14	Nipple, 3/4" x 5"	24.	4228-508	Bandit Clamp
11.	2223-000	Combo Valve (See page 15)	25.	4102-006	Air Hose, 1" (per foot)
12.	2401-506	Ball Valve, 1" full port	26.	3010-007-06	90° Elbow, 1 1/4" x 1"
13.	3008-006	45° Street Elbow, 1"	27.	2263-000	Deadman, pneumatic (See page 16)
14.	3010-006-05	90° Elbow, 1" x 3/4"	28.	4100-501	Twinline Hose Assembly, 55 ft
15.	3029-007-99	Nipple, 1 1/4" x close		4100-701	Twinline Hose Assembly, 110ft