

**Apollo 60 HP is for use with compressed air.**

Item Description	Stock No.	Wt.
------------------	-----------	-----

**Apollo 60 HP less respirator hose with:**

Constant-flow connector .....	21300	8
Air-control valve .....	10505	8
Cool-air tube .....	10508	8
Climate-control tube .....	10509	9

**Apollo 60 HP with 50 ft. respirator hose and:**

Constant-flow connector .....	20213	16
Air-control valve .....	10510	16
Cool-air tube .....	10511	16
Climate-control tube .....	10512	17

**Apollo 60 HP with 50 ft. respirator hose,  
CPF 20 air filter and:**

Constant-flow connector .....	20214	36
Air-control valve .....	10513	36
Cool-air tube .....	10514	36
Climate-control tube .....	10515	37

(-) Noise-reduction ear muffs rated 21dB .....	23886	.5
(-) Apollo 60 HP to 60 LP Conversion kit .....	22079	10
(-) APF 1000 Conversion kit .....	22688	<.5
1. Air control valve with belt .....	100024	1
2. Respirator hose, 3/8" x 25 ft. incl. items 5 & 6 .....	04397	3
3. Respirator hose, 3/8" x 50 ft. incl. items 5 & 6 .....	04415	6
4. Respirator hose, 3/8" x 100 ft. incl. items 5 & 6 .....	04398	12
5. Adaptor, 3/8" hose to 3/8" pipe .....	00022	<.5
6. Union, 3/8" hose to 3/8" hose .....	01020	<.5
7. Disconnect, 1/4" female .....	00025	<.5
8. Adaptor, 3/8" hose to 1/4" pipe .....	01019	<.5
9. Acoustical foam kit .....	04369	<.5
10. Gasket, window .....	04452	<.5
11. Inner lens, .040", pk of 5 .....	04367	1
12. Outer lens, .0075" perforated, pk of 25 .....	04361	1
.003" non-perforated, pk of 25 ....	04372	1
.020" non-perforated, pk of 25 ....	04373	1
13. Window frame kit .....	08741	<.5
14. Chin strap .....	04460	<.5
15. Handle strap .....	03623	<.5
16. Suspension .....	10532	<.5

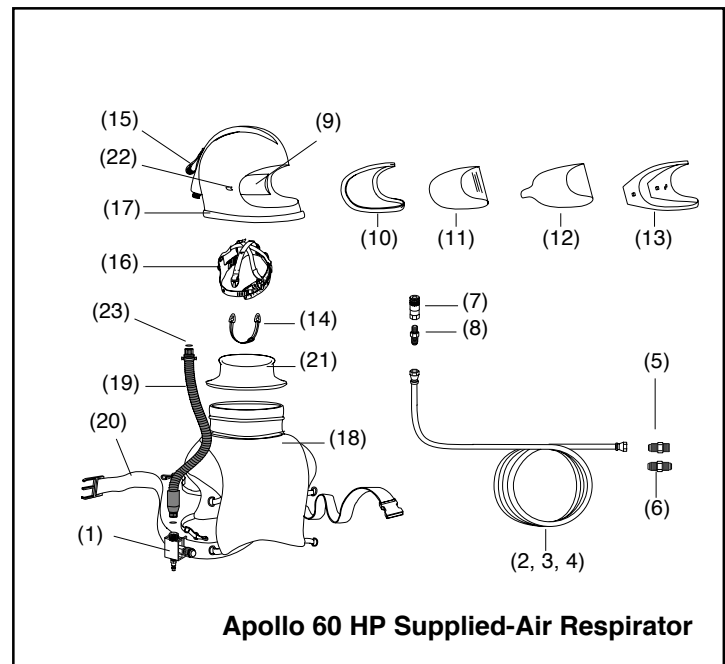

Item Description	Stock No.	Wt.
17. Cape attachment strap .....	10534	1
18. Cape w/inner collar .....	04435	1
19. Breathing tube .....	22811	1
20. Belt assembly, 2" .....	04430	<.5
21. Inner collar kit .....	08740	<.5
22. Window latch kit .....	04368	<.5
23. O-ring .....	22815	<.5
(-) Box window assembly .....	04515	1

**Value-pack Bulk Lens Packages**

04367 inner lens (pk of 5), 80 pks .....	23065	51
04361 outer lens (pk of 25), 80 pks .....	23064	56
04373 outer lens (pk of 25), 32 pks ...	23067	49

NOTE: THE OCCUPATIONAL SAFETY AND HEALTH ADMINISTRATION (OSHA) HAS ASSIGNED APOLLO HELMETS A PROTECTION FACTOR OF 1,000 TIMES THE EXPOSURE LIMIT FOR LEAD DUST.

### APPLICATION ALERT

**Above respirators ARE NOT approved for use in any atmosphere immediately dangerous to life or health or from which the wearer cannot escape without the aid of the respirator. Before using any respirator, make sure that any airborne contaminants ARE NOT in concentrations that are in excess of those allowed by applicable OSHA or EPA regulations or NIOSH recommendations. Consult the product literature and owner's manuals for information concerning the proper function, use and maintenance of these respirators.**