

Model 2024: 6.0 cuft Blast Machine, Contractor 150 psi working pressure

Item Description	Stock No.	Wt.
6 cuft	21610	583
Includes		
1 1/2" Millennium remote controls		
Quantum all-media metering valve		
Abrasive trap		
RLX pneumatic handle		
Above Blast Machine	21546	598
with CPF-20 air filter w/pressure regulator and gauge		
6 cuft Blast Machine with Pressure-release Millennium remotes		
Pneumatic w/ACS	22555	608
12V electric	21543	618
12V electric w/ACS	22542	638
120V electric	21606	618
120V electric w/ACS	22544	638
6 cuft Blast Machine with Pressure-hold Quantum remotes and Abrasive Cut-Off (ACS)		
Pneumatic	22546	598
12V electric	22548	628
120V electric	22550	628
System		
2006-CA	21549	680
Includes: 21610 contractor machine, Apollo 60 HP (for use with compressed air) respirator w/Cool-Air Tube, (25) Helmet outer lenses, CPF 20 breathing-air filter and Accessory Package		

Item Description	Stock No.	Wt.
------------------	-----------	-----

Accessory Package

1 1/2" air filter w/ manual drain	22363	
50 ft. x 1 1/4" Supra hose w/ NHP-2 and CQPS-2	23481	
Blast hose safety cable	15013	
TXP-6 nozzle	23525	
Blast machine screen, 24"	03100	
Poly all-weather cover	15143	
Leather gloves, 1 pair	02243	
Nylon ties, 8 ea.	02195	
CQGP-3 coupling gaskets, pk of 10	08853	
NW-32 nozzle washers, pk of 10 ...	91026	
Abrasive trap screens, (6)	02012	

Options/Accessories

Steel blast machine cover, 24"	02336	10
Carbon monoxide alarm, CMS-2	22894	9
Blast suit, heavy cotton/leather S (08920), M (08921), L (08922), XL (08923)		5
Blast suit, seasonal cotton/nylon M (22914), L (22915), XL (22916), XXL (22917)		3
Remote control conversion kits (field installed) for Millennium pressure-release remotes		
ACS	22551	20
Pneumatic to Electric		
12V	21678	30
120V	21679	30

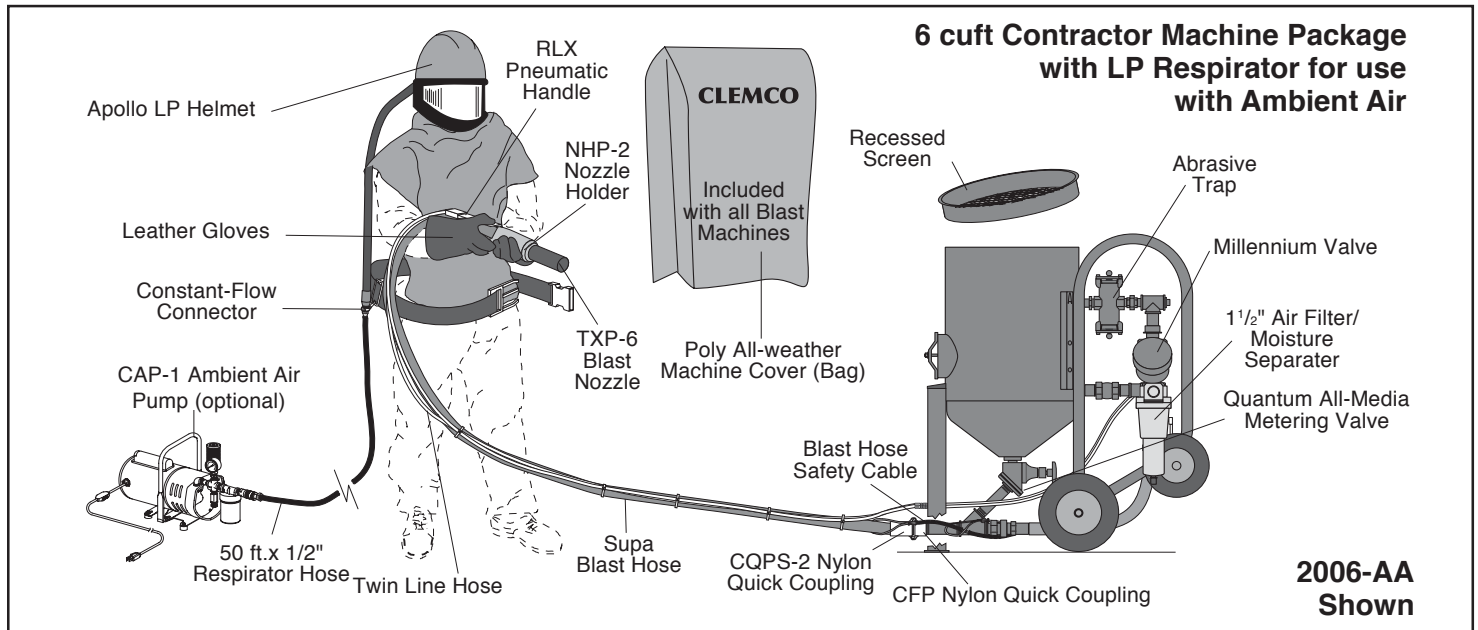

Model 2024: 6.0 cuft Blast Machine, Contractor 150 psi working pressure

Item Description	Stock No.	Wt.
6 cuft	21610	583
Includes		
1 1/2" Millennium remote controls		
Quantum all-media metering valve		
Abrasive trap		
RLX pneumatic handle		
6 cuft Blast Machine with Pressure-release Millennium remotes		
Pneumatic w/ACS	22555	608
12V electric	21543	618
12V electric w/ACS	22542	638
120V electric	21606	618
120V electric w/ACS	22544	638
6 cuft Blast Machine with Pressure-hold Quantum remotes and Abrasive Cut-Off (ACS)		
Pneumatic	22546	598
12V electric	22548	628
120V electric	22550	628

Systems

2006-AA	21842	680
Includes: 21610 contractor machine, Apollo 60 LP (for use with ambient air) respirator w/CFC, (25) Helmet outer lenses and Accessory Package		

Item Description	Stock No.	Wt.
------------------	-----------	-----

Accessory Package

1 1/2" air filter w/ manual drain	22363	
50 ft. x 1 1/4" Supa hose w/ NHP-2 and CQPS-2	23481	
Blast hose safety cable	15013	
TXP-6 nozzle	23525	
Blast machine screen, 24"	03100	
Poly all-weather cover	15143	
Leather gloves, 1 pair	02243	
Nylon ties, 8 ea.	02195	
CQGP-3 coupling gaskets, pk of 10	08853	
NW-32 nozzle washers, pk of 10 ...	91026	
Abrasive trap screens, (6)	02012	

Options/Accessories

Steel blast machine cover, 24"	02336	10
Carbon monoxide alarm, CMS-2	22894	9
CAP-1 single operator	22383	65
CAP-4 four operators w/ frame	22530	175
CAP-4C four operators with 2 wheel cart	22384	205
Blast suit, heavy cotton/leather		
S (08920), M (08921), L (08922), XL (08923)		5
Blast suit, seasonal cotton/nylon		
M (22914), L (22915), XL (22916), XXL (22917)		3
Remote control conversion kits (field installed) for Millennium pressure-release remotes		
ACS	22551	20
Pneumatic to Electric		
12V	21678	30
120V	21679	30

Create a Custom Blast Machine System

Select the appropriate stock numbers from each category:

Category 1: Blast Machine

6 cuft 21610 583

Includes
 1 1/2" Millennium remote controls
 Quantum all-media metering valve
 Abrasive trap
 RLX pneumatic handle

6 cuft Blast Machine with Pressure-release Millennium remotes

Pneumatic w/ACS	22555	608
12V electric	21543	618
12V electric w/ACS	22542	638
120V electric	21606	618
120V electric w/ACS	22544	638

6 cuft Blast Machine with Pressure-hold Quantum remotes and Abrasive Cut-Off (ACS)

Pneumatic	22546	598
12V electric	22548	628
120V electric	22550	628

Category 2: Respirator/Breathing-Air Source

Respirator for use with compressed air beathing-air source

Apollo 60 HP with cool-air tube, 50 ft. respirator hose, and CPF-20 breathing-air filter	10514	36
--	-------	----

Respirators for use with ambient air beathing-air source

Apollo 60 LP with constant-flow connector, 50 ft. respirator hose	22082	22
---	-------	----

Ambient Air Pump

CAP-1 single operator	22383	65
CAP-4 four operators w/ frame ...	22530	175
with 2 wheel cart	22384	205

Category 3: Accessory Package

Item Description	Stock No.	Wt.
Accessory Package Complete	22553	100
Accessory Package consists of:		
1 1/2" air filter w/ manual drain	22363	
50 ft. x 1 1/4" Supa hose w/ NHP-2 and CQPS-2	23481	
Blast hose safety cable	15013	
TXP-6 nozzle	23525	
Blast machine screen, 24"	03100	
Leather gloves, 1 pair	02243	
Nylon ties, 8 ea.	02195	
CQGP-3 coupling gaskets, pk of 10	08853	
NW-32 nozzle washers, pk of 10 ...	91026	
Abrasive trap screens, (6)	02012	
Apollo 60 outer lenses, pk of 25	04361	

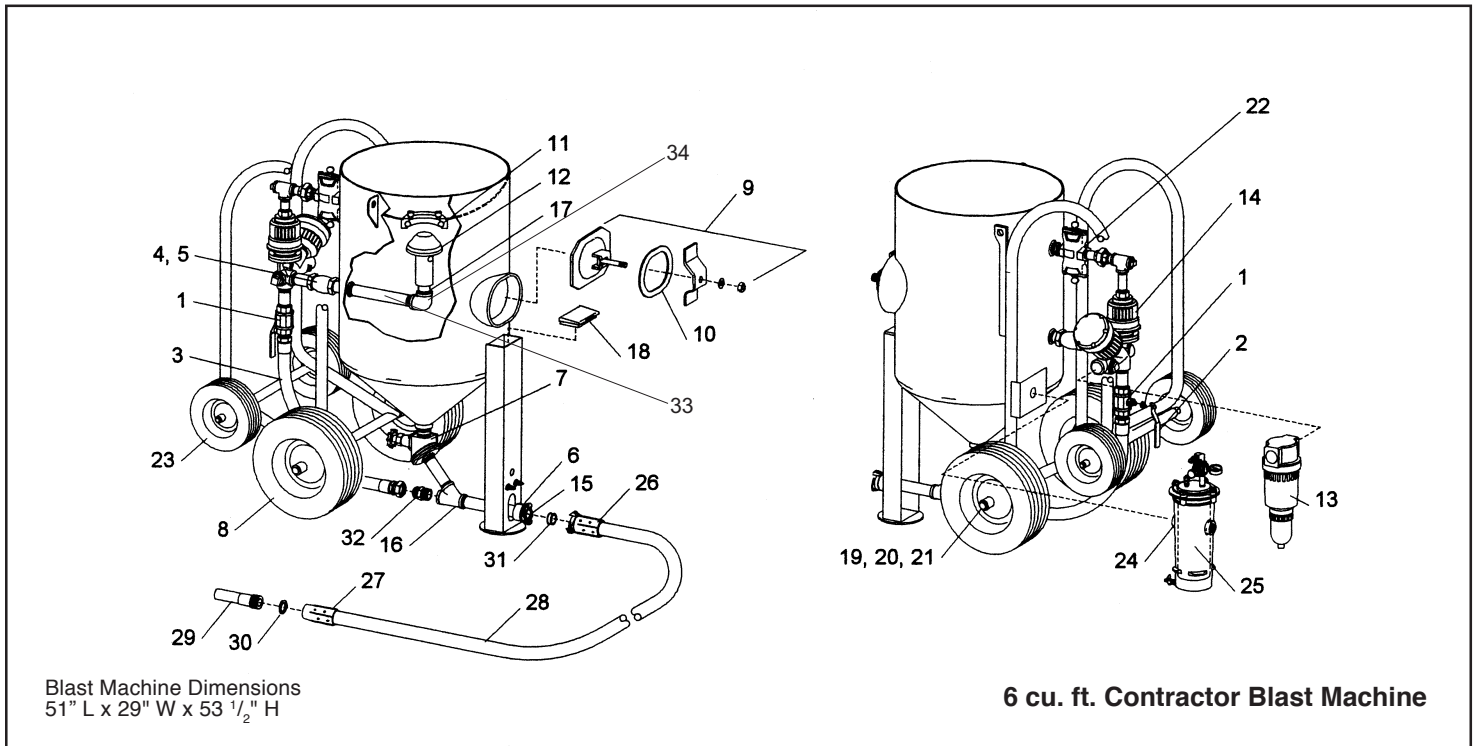

Model 2024: 6.0 cuft Blast Machine, Contractor 150 psi working pressure

Item Description	Stock No.	Wt.
1. 1 1/4" ball valve w/handle	02397	3
2. Ball valve handle	22532	<.5
3. Replacement flexible pusher line, coupled hose only	23675	4
4. Compression coupling	01857	2
5. Compression coupling gasket ...	01886	<.5
6. Threaded quick coupling w/nipple	21735	2
7. Manual Quantum valve	22845	9
8. 16" wheel	20427	10
9. Inspection door assy	02377	7
10. Inspection door gasket	02369	.5
11. Pop-up valve seal	02325	.5
12. Pop-up valve	03699	5
13.* Air filter	22363	8
14. Millennium valve	21336	20
15.* CQGP-3 gasket, pkg. of 10	08853	<.5
16. Wye std. 1 1/4"	01818	<.5
17. Pop-up valve guide, 6"	01753	1.5
18. Rain cap	21517	1

Item Description	Stock No.	Wt.
19. Axle	02402	10
20. 1" thrust washer	03825	<.5
21. 1" retaining ring	03824	<.5
22. Abrasive trap	02011	4
23. 10" wheel	20349	6
24.* CPF-20 air filter	03578	21
25. Cartridge, CPF filter	03547	9
26.* Coupling, CQPS-2	08413	.5
27.* NHP-1 nozzle holder	04127	.5
28.* Blast hose 1 1/4" ID x 50 ft.	23106	
29.* Nozzle, TXP-6	23525	
30.* NW-25 washer 10 pk	91026	<.5
31.* CQGP-3 gasket 10 pk	08853	<.5
32. Adaptor 1 1/4" NPT	22529	<.5
33. 1 1/4" Std. Pipe x 10" nipple	01726	4
34. 1 1/4" elbow	01769	<.5
(-) * 24" dia. machine cover	02336	10
(-) * 24" dia. screen	03100	10
(-) * Flexible pusher line conversion kit	23876	5

* Optional Accessories.

Manual

6 cuft Contractor21941